

EPIC® H-B 10 AD-LB

H-B.

가

UL50E

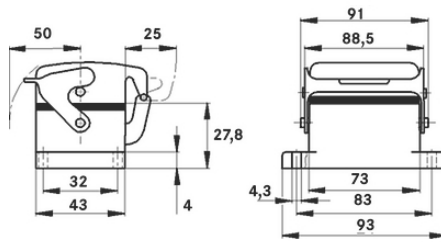

Lapp



가 가

가

(17.07.2024)

©2024 Lapp Group - all rights reserved.

<http://lappkorea.lappgroup.com>

data sheet

PN 0456 / 02_03.16

EPIC® H-B 10 AD-LB

H-A case: Wall base
가

ETIM 5:

ETIM 5.0 Class-ID: EC000437
ETIM 5.0 class :

ETIM 6:

ETIM 6.0 Class-ID: EC000437
ETIM 6.0 Class-Description: Housing for industrial connectors

:

: - ,
:
: NBR

가:

IP 65 (latched)
NEMA 250, UL50E: 12 (latched)

VDE- :

: VDE-REG. : B437

UL- :

UL : E75770

:

-40°C to +100°C, short-term up to +125°C

가 VAT 가 가 .

(17.07.2024)



EPIC® H-B 10 AD-LB

	Article description	M	Packaging unit
H-B : - (,)			
10033900	H-B 10 AD-LB	AG	10

(17.07.2024)

©2024 Lapp Group - all rights reserved.

<http://lappkorea.lappgroup.com>

data sheet

PN 0456 / 02_03.16