

EPIC® H-A 3

2.5 mm²

H-A

Made in Germany

가



M

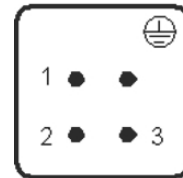

F

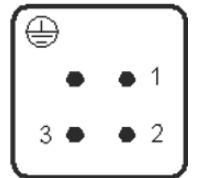

Lapp



H-A 3 / H-A 4

(16.08.2024)

EPIC® H-A 3

가

Railway applications

- Fire protection on railway vehicles: Test according EN 45545-2. Requirement sets R22 and R23. Hazard level HL1, HL2 and HL3

/

ETIM 5:

ETIM 5.0 Class-ID: EC000438

ETIM 5.0 class :

ETIM 6:

ETIM 6.0 Class-ID: EC000438

ETIM 6.0 Class-Description: Contact insert for industrial connectors

(V):

IEC: 400 V

UL: 600 V

CSA: 600 V

:

4 kV

(A):

IEC: 23 A

UL: 10 A

CSA: 10 A

:

3

:

UL94 V-0

:

1.5 - 4 mohm

:

/ :

3 + PE

:

: 0.5 - 2.5 mm² (가 2.5 mm²)

(mm):

6

:

100

VDE- :

: VDE-REG. : B437

UL- :

UL : E75770

:

-40°C to +100°C, short-term up to +125°C

가 VAT 가 가 .

(16.08.2024)

©2024 Lapp Group - all rights reserved.

<http://lappkorea.lappgroup.com>

data sheet

PN 0456 / 02_03.16



EPIC® H-A 3

	Article description	Contact type		Packaging unit
H-A 3				
10420000	H-A 3 SS		1 - 3	10
10421000	H-A 3 BS		1 - 3	10

(16.08.2024)

©2024 Lapp Group - all rights reserved.

<http://lappkorea.lappgroup.com>

data sheet

PN 0456 / 02_03.16

EPIC® H-A 3

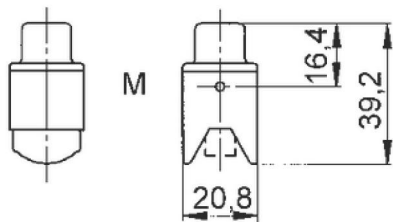
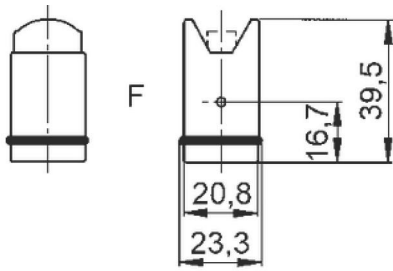

(16.08.2024)