

EPIC® SIGNAL M23 A3

Servo

EPIC® M23

Made in Germany 가

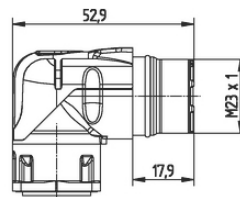
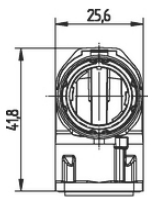

(24.04.2024)



EPIC® SIGNAL M23 A3

Mounting: Ø2.7mm for screws M2.5. Ø3.2mm for screws M3

ETIM 5:

ETIM 5.0 Class-ID: EC000437

ETIM 5.0 class :

ETIM 6:

ETIM 6.0 Class-ID: EC000437

ETIM 6.0 Class-Description: Housing for industrial connectors

:

: - -

: FPM

가:

IP 65

VDE- :

: VDE-REG. C24(EN 61984 , DIN

VDE 0100-410 SELV가)

UL : E249137

:

-25°C ~+125°C

가 VAT 가 가 .

(24.04.2024)

©2024 Lapp Group - all rights reserved.

<http://lappkorea.lappgroup.com>

data sheet

PN 0456 / 02_03.16



EPIC® SIGNAL M23 A3

	Article			/ PU
M23 A3	- , , 가 ,			
24420055	M23 A3	(N)	Ø 2.7 mm (4x)	5
24420054	M23 A3	(N)	Ø 2.7 mm (4x)	20

(24.04.2024)

©2024 Lapp Group - all rights reserved.

<http://lappkorea.lappgroup.com>

data sheet

PN 0456 / 02_03.16