

EPIC® POWER LS1 G5

EPIC® LS1 Power connector panel base with M25 thread for male contacts

Made in Germany

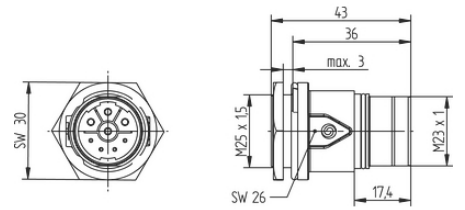
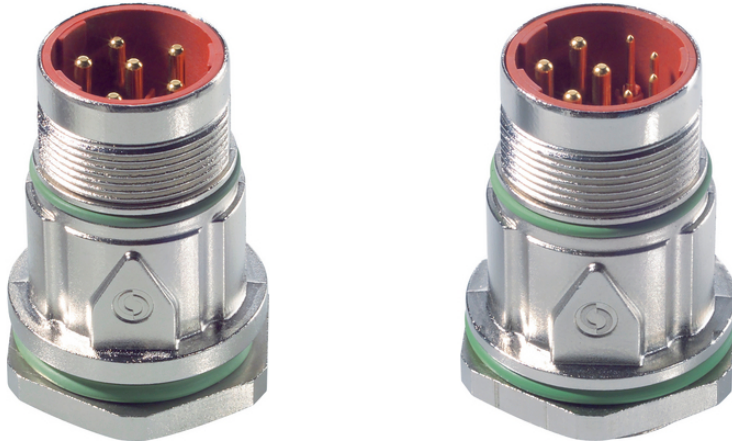

(20.07.2024)

EPIC® POWER LS1 G5



EMC

ETIM 5:	ETIM 5.0 Class-ID: EC002635
	ETIM 5.0 class : ()
ETIM 6:	ETIM 6.0 Class-ID: EC002635
	ETIM 6.0 Class : ()
(V):	630 V (2 mm)
	250 V (1 mm)
:	6 kV (2 mm)
	4 kV (1 mm)
(A):	26A/3+PE+4, 25A/5+PE(2mm)
	7 A (1 mm)
:	3
:	< 4 mOhm
:	
/ :	3+PE+4(2mm/1mm)
	5+PE(2mm)
:	: 0.5 - 2.5 mm ² (2 mm contacts)
	: 0.14 - 1.0 mm ² (1 mm contacts)
:	:
	: PA,
	: FPM
가:	IP68 (10h/1m)
:	500
VDE- :	: VDE-REG. B25
	UL : E249137
:	-25°C ~+125°C

(20.07.2024)



EPIC® POWER LS1 G5

가 VAT 가 가 .

(20.07.2024)

©2024 Lapp Group - all rights reserved.

<http://lappkorea.lappgroup.com>

data sheet

PN 0456 / 02_03.16



EPIC® POWER LS1 G5

	Article description		Clamping range in mm			Packaging unit
	LS1 G5, , 6 ,					
76153000	LS1 G5	6	-	M25 x 1.5 (with nut)	5+PE	5
76153510	LS1 G5	-	-	M25 x 1.5 (with nut)	5+PE	20
	LS1 G5, , 8 ,					
76154000	LS1 G5	8	-	M25 x 1.5 (with nut)	3+PE+4	5
76154510	LS1 G5	-	-	M25 x 1.5 (with nut)	3+PE+4	20

(20.07.2024)

©2024 Lapp Group - all rights reserved.

<http://lappkorea.lappgroup.com>

data sheet

PN 0456 / 02_03.16