

# UNITRONIC® BUS ASI

AS-INTERFACE

/ . ( ), UL (PVC ), (TPE ). : -40°C ~ +90°C

"LD" =



BUS ASI LD 2 x 2.5 (Long Distance) 가 . AS-I  
 . BUS ASI LD 1.5 -

/ UNITRONIC® Fieldbus

-/

TPE 가 , 가 ,

(23.04.2024)

©2024 Lapp Group - all rights reserved.

<http://lappkorea.lappgroup.com>

data sheet

PN 0456 / 02\_03.16

# UNITRONIC® BUS ASI

ASI ( ) 2- ( ) (Polarity Reversal)

ASI EN 50295 IEC 62026-2  
 UL/CSA(CMX) PVC A  
 UL/CSA : CMGc(UL)us (UL)CL2 AWM 300V FT4

: 가  
 :  
 (G), (TPE) PVC  
 : (RAL 1023) (RAL 9005)

ETIM 6: ETIM 6.0 Class-ID: EC000830  
 ETIM 6.0 Class :  
 : 300 V ( )  
 : 300 V ( )  
 : 300 V  
 : 1.5 mm<sup>2</sup>: . 13.7 Ohm/km  
 2.5 mm<sup>2</sup>: . 8.21 Ohm/km  
 : : 12 mm  
 24 mm  
 : Core/core: 2000 V  
 :  
 PVC: -30°C ~ +90°C  
 : -40°C ~ +85°C  
 :  
 PVC -20 °C to +90 °C  
 :  
 -30 °C to +85 °C

가 가 ( ) 가  
[www.lappkabel.de/en/cable-standradlengths](http://www.lappkabel.de/en/cable-standradlengths)  
 Lapp Kabel AS-International Association  
 가 VAT 가 가

UNITRONIC® BUS ASI

				(CORE) / (mm <sup>2</sup> )	(kg/km)	(kg/km)
/EPDM						
2170228	UNITRONIC® BUS ASI (G)			2 x 1.5	29	85
2170229	UNITRONIC® BUS ASI (G)		30 V DC	2 x 1.5	29	85
2170371	UNITRONIC® BUS ASI LD (G)			2 x 2.5	48	85
2170372	UNITRONIC® BUS ASI LD (G)		30 V DC	2 x 2.5	48	85
TPE						
2170230	UNITRONIC® BUS ASI (TPE)			2 x 1.5	29	64
2170231	UNITRONIC® BUS ASI (TPE)		30 V DC	2 x 1.5	29	64
2170232	UNITRONIC® BUS ASI (TPE)		230 V AC	2 x 1.5	29	64
PVC UL/CSA						
2170842	UNITRONIC® BUS ASI (PVC) A			2 x 1.5	29	70
2170843	UNITRONIC® BUS ASI (PVC) A		30 V DC	2 x 1.5	29	70
2170844	UNITRONIC® BUS ASI (PVC) A		230 V AC	2 x 1.5	29	70

(23.04.2024)

©2024 Lapp Group - all rights reserved.

<http://lappkorea.lappgroup.com>

data sheet

PN 0456 / 02\_03.16

# UNITRONIC® BUS ASI

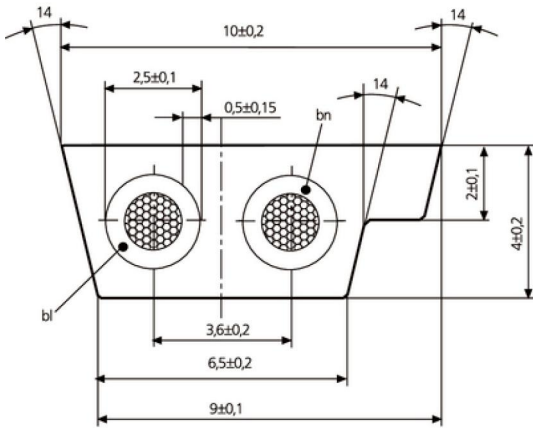

(23.04.2024)