

## SKINDICHT® RWV

SKINDICHT® RWV,



**CE UK  
CA**



PG

: SKINDICHT® SM

For combination with other SKINDICHT® or SKINTOP® cable glands, we propose our SKINDICHT® RWV without incised

(24.04.2024)

©2024 Lapp Group - all rights reserved.

<http://lappkorea.lappgroup.com>

data sheet

PN 0456 / 02\_03.16

# SKINDICHT® RWV

sealing ring (E) and compression screw (D)

ETIM 5:

ETIM 5.0 Class-ID: EC000441

ETIM 5.0 :

ETIM 6:

ETIM 6.0 Class-ID: EC000441

ETIM 6.0 Class :

:

:

:

: CR

O- : NBR

가:

IP 55

:

-20°C +80°C

: -20°C +100°C

가 VAT 가 가 .

(24.04.2024)

©2024 Lapp Group - all rights reserved.

<http://lappkorea.lappgroup.com>

data sheet

PN 0456 / 02\_03.16

	Article designation / size	A (mm)	B in mm	G mm	Ø B mm	ØF (mm)	mm , C	Thread length D mm	SW1/SW2 mm	/ PU
SKINDICHT® RWV										
52004180	PG 7	20.5	8	14	15.3	5	26.0	8.5	15.0 / 13.0	25
52004190	PG 9	23.5	10	17	18.3	5/8	28.0	9.5	18.0 / 15.0	25
52004200	PG 11	26	12	20	21.9	7/10/12.5	31.5	10	21.0 / 18.0	25
52004210	PG 13,5	28.5	14	22	24	7/10.5/13/16	34.5	10.5	23.0 / 20.0	25
52004220	PG 16	31	16	24	26.1	8/10.5/13.5/16	35.5	11	26.0 / 22.0	10
52005420	PG 21	33.5	21	30	32.5	11/15/18/20	42.5	11.5	32.0 / 28.0	10
52004225	PG 29	43	30	40	42	19/23/27/31	49.0	13	41.0 / 37.0	10
SKINDICHT® RWV, E+D										
52024020	PG 7	20.5	-	14	15.3	-	20.2	8.5	15.0 / 13.0	25
52023970	PG 9	23.5	-	17	18.3	-	21.8	9.5	18.0 / 15.0	25
52023980	PG 11	26	-	20	21.9	-	24.9	10	21.0 / 18.0	25
52023990	PG 13,5	28.5	-	22	24	-	27.4	10.5	23.0 / 20.0	25
52024000	PG 16	31	-	24	26.1	-	28.5	11	26.0 / 22.0	10
52024010	PG 21	33.5	-	30	32.5	-	34.8	11.5	32.0 / 28.0	10
52024015	PG 29	43	-	40	42	-	41.2	13	41.0 / 37.0	10

(24.04.2024)

©2024 Lapp Group - all rights reserved.

<http://lappkorea.lappgroup.com>

data sheet

PN 0456 / 02\_03.16

# SKINDICHT® RWV

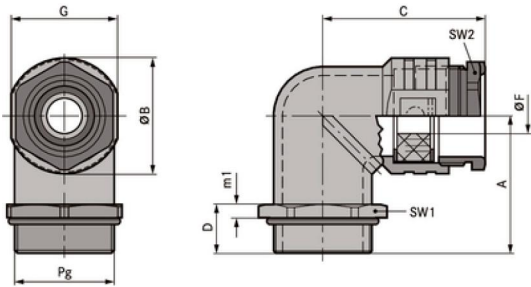

(24.04.2024)

©2024 Lapp Group - all rights reserved.  
<http://lappkorea.lappgroup.com>

data sheet

PN 0456 / 02\_03.16