

70474000	DATA SHEET	
Valid from: 19.06.2024	EPIC® H-A 16 AD-LB	

Description

- These connectors are attractive because of their compact housing.
- Small and compact for applications with high number of contacts
- Panel mount base housing with protective cover to protect the insert when not plugged in



General characteristics

Series	H-A 16
Design size	16A
Version	Panel-mount base
Locking	single lever
Protection cover	yes
Protection (DIN EN 60529)	IP 65 (latched)
Protection (NEMA 250, UL50E)	4, 12 (latched)
Temperature range	-40°C to +100°C, short-term up to +125°C

Materials and surfaces

Housing	Aluminium alloy, powder-coated, grey
Protection cover	Zinc alloy, powder-coated, grey
Lever	Steel, zinc-plated
Gasket	NBR

Approvals

VDE-Approval, VDE-REG.-Nr.	B437
UL File Number	E75770

Standards

Safety Standard	IEC 61984, UL1977, UL50E, CSA 22.2 182.3, CSA 22.2 94.2-07
-----------------	------------------------------------------------------------

Certificates:



REG.-Nr. B437

Creator: THB01/BU-EPIC Released: IVSE1/ BU-EPIC	Document: DB70474000EN Version: 03	Page 1 of 2
----------------------------------------------------	---------------------------------------	-------------

70474000	DATA SHEET	
Valid from: 19.06.2024	EPIC® H-A 16 AD-LB	

Drawings

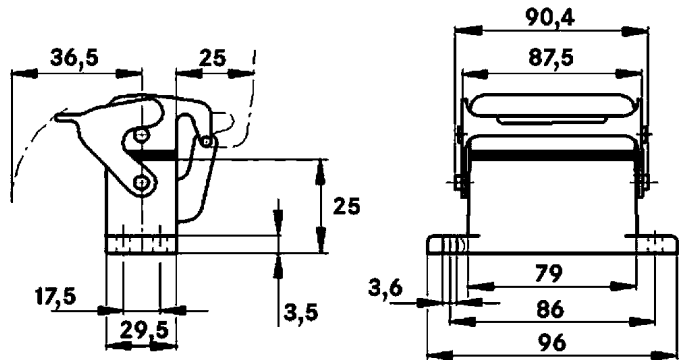

Industrial machinery and plant engineering



Mechanical resistance



Robust



Waterproof

Info

Compact, robust metal housings size 16A

Application range

Machine and equipment manufacturing
Control engineering
Electronic laboratory

Remark

Photographs are not to scale and do not represent detailed images of the respective products.

Creator: THB01/BU-EPIC Released: IVSE1/ BU-EPIC	Document: DB70474000EN Version: 03	Page 2 of 2
----------------------------------------------------	---------------------------------------	-------------